

**SPACE AVAILABLE  
FOR LEASE  
VICTORVILLE, CA**

**13650 BEAR VALLEY RD**



**PROPERTY INFORMATION**

**SPACE AVAILABLE:** 50,095 SF

**SIGNAGE AVAILABLE:** MONUMENT

**FEATURES:**

- LARGE PARKING FIELD
- EXCELLENT ACCESS AND VISIBILITY
- ADJACENT TO CVS/PHARMACY IN EXCELLENT SHOPPING CENTER
- GREAT FRONTAGE AND SIGNAGE ALONG BEAR VALLEY & AMETHYST RD
- TRAFFIC COUNTS OF OVER 40,000 CPD

**DEMOGRAPHICS**

**2017 ESTIMATED POPULATION**

1 Mile: 8,975  
3 Mile: 69,077  
5 Mile: 175,105

**2017 ESTIMATED AVG. HH INCOME**

1 Mile: \$93,247  
3 Mile: \$75,301  
5 Mile: \$67,995

**2017 ESTIMATED TRAFFIC COUNTS**

43,209 CPD – BEAR VALLEY ROAD  
13,278 CPD – AMETHYST ROAD



Carol Springstead CA BRE #01802067

[cspringstead@Springstead-associates.com](mailto:cspringstead@Springstead-associates.com)

Mike Lucero CA BRE #01999903

[mlucero@Springstead-associates.com](mailto:mlucero@Springstead-associates.com)

**SPRINGSTEAD & ASSOCIATES, INC.**  
3300 IRVINE AVE. STE 250  
NEWPORT BEACH, CA 92660  
P: 949-797-9040 F: 949-797-9041  
[WWW.SPRINGSTEAD-ASSOCIATES.COM](http://WWW.SPRINGSTEAD-ASSOCIATES.COM)



SPACE AVAILABLE  
FOR LEASE  
VICTORVILLE, CA

# 13650 BEAR VALLEY RD

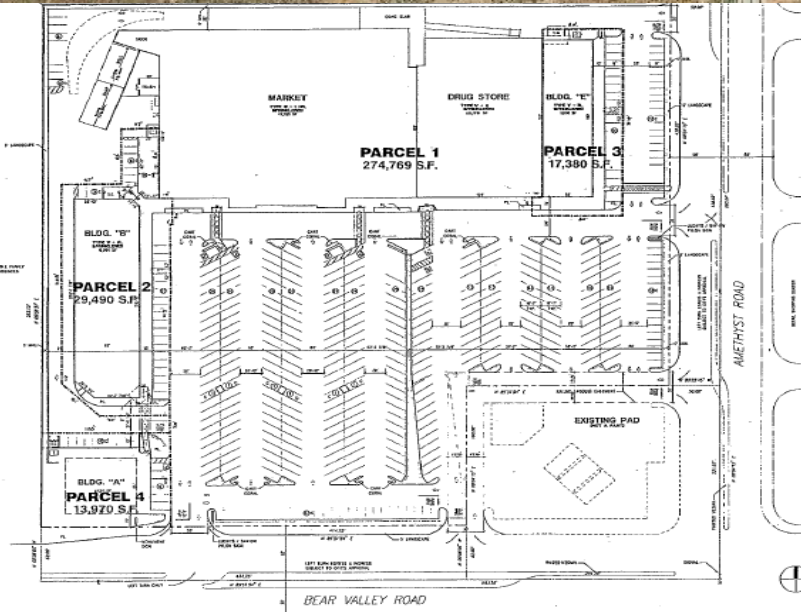

Carol Springstead CA BRE #01802067  
[cspringstead@Springstead-associates.com](mailto:cspringstead@Springstead-associates.com)  
Mike Lucero CA BRE #01999903  
[mlucero@Springstead-associates.com](mailto:mlucero@Springstead-associates.com)

SPRINGSTEAD & ASSOCIATES, INC.  
3300 IRVINE AVE. STE 250  
NEWPORT BEACH, CA 92660  
P: 949-797-9040 F: 949-797-9041  
[WWW.SPRINGSTEAD-ASSOCIATES.COM](http://WWW.SPRINGSTEAD-ASSOCIATES.COM)